

# Horse Schedule 2018

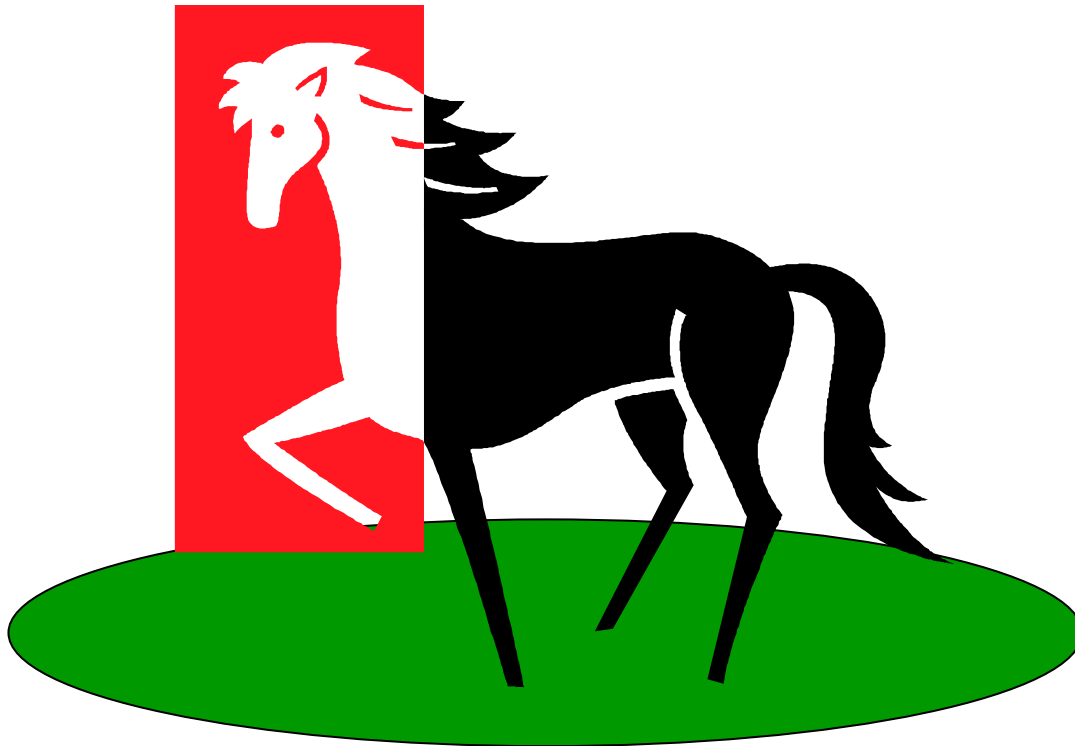

## **Bunyip & District Annual Show**

Sunday 25<sup>th</sup> March 2018

Email: [bunyipshow@gmail.com](mailto:bunyipshow@gmail.com)

Website: [www.bunyipshow.org.au](http://www.bunyipshow.org.au)

Facebook Page: Bunyip & District  
Agricultural Society Inc

**Entries closing date: Friday 16th March 2018.  
Entries accepted on day at higher rate.**

## **Securing horse health at shows and events**

Shows and events are prime places for your horse to catch an infectious disease. Simple measures can help reduce that risk and protect the health of your horse.

### **Horse movement**

#### **Pre-travel:**

When attending shows or events, always check your horse thoroughly beforehand. It is never wise to transport a sick animal unnecessarily in case it gets worse, and you shouldn't risk the health of other horses by exposing them to your sick.

Check with your vet whether any vaccinations are recommended and ensure they are up to date.

Keep records of movements on and off your property.

#### **Stay separate:**

When at the show, it is best if your horse is not housed too closely with other horses where possible.

Make sure the stable or housing areas have been adequately cleaned before you allow your horse to enter and avoid yards that have a lot of weeds.

Keep your horse away from swampy areas, bat colonies, piggeries etc. as these may be carriers of some viruses that can affect horses. If the housing areas are located near to any of these do not allow your horse to enter.

Keep an eye on your horse's health throughout the show or event. You will be in the best position to notice any changes in health or behaviour if you have been checking regularly.

If you are at the event for longer than one day, take your horse's rectal temperature regularly. A fever suggests the presence of disease (around 38 degrees is normal).

If you notice strange behaviour or signs of disease in your horse, or any horse, report it immediately to the show convenor so they can determine the risk to other horses. Do not move the horse.

#### **Returning home:**

Make sure you clean and disinfect your vehicle thoroughly before returning to your property. Remove all dirt and manure, which can carry disease, to ensure you are not taking anything nasty home with you.

Keep returning horses away from other horses on the property for 10 days. If they are sick, it will prevent the disease from being passed on.

### **People**

Discourage people from touching your horse as this is a key way for disease to spread from horse to horse.

Wash your hands between handling horses.

Make sure that vet staff/personnel clean and disinfect equipment and themselves before touching your horse.

Do not allow strangers to feed your horse. If you arrange someone else to feed your horse whilst at the show, make sure they do not use the same equipment on other horses first.

### **Vehicles and equipment**

#### **Bring Your Own Equipment:**

If at all possible, do not borrow equipment from other attending horse owners, or from show/event facilities. If you do need to borrow anything, clean and disinfect it thoroughly before use.

#### **Keep Your Trailer Clean:**

Horse trailers should be cleaned and disinfected between each use, both inside and outside. Don't forget to disinfect the wheels as well.

### **Feed and water**

#### **Don't Share Germs:**

If at all possible, do not allow your horse to drink from shared water buckets or eat from shared feed bins. Bring your own.

#### **Pests and weeds**

Make sure there are no noxious weeds in areas where your horse is being housed or feeding and that feed is stored properly to prevent pests from gaining entry.

**Most importantly, follow all required biosecurity measures at the venue.**

#### **Horse biosecurity:**

Make certain the only thing your horse brings back from the show is a ribbon.

**Handy tip: diluted truck detergent is an acceptable disinfectant. Always read the instructions.**

Further information is available at: [www.farmbiosecurity.com.au](http://www.farmbiosecurity.com.au)

# Map of Grounds

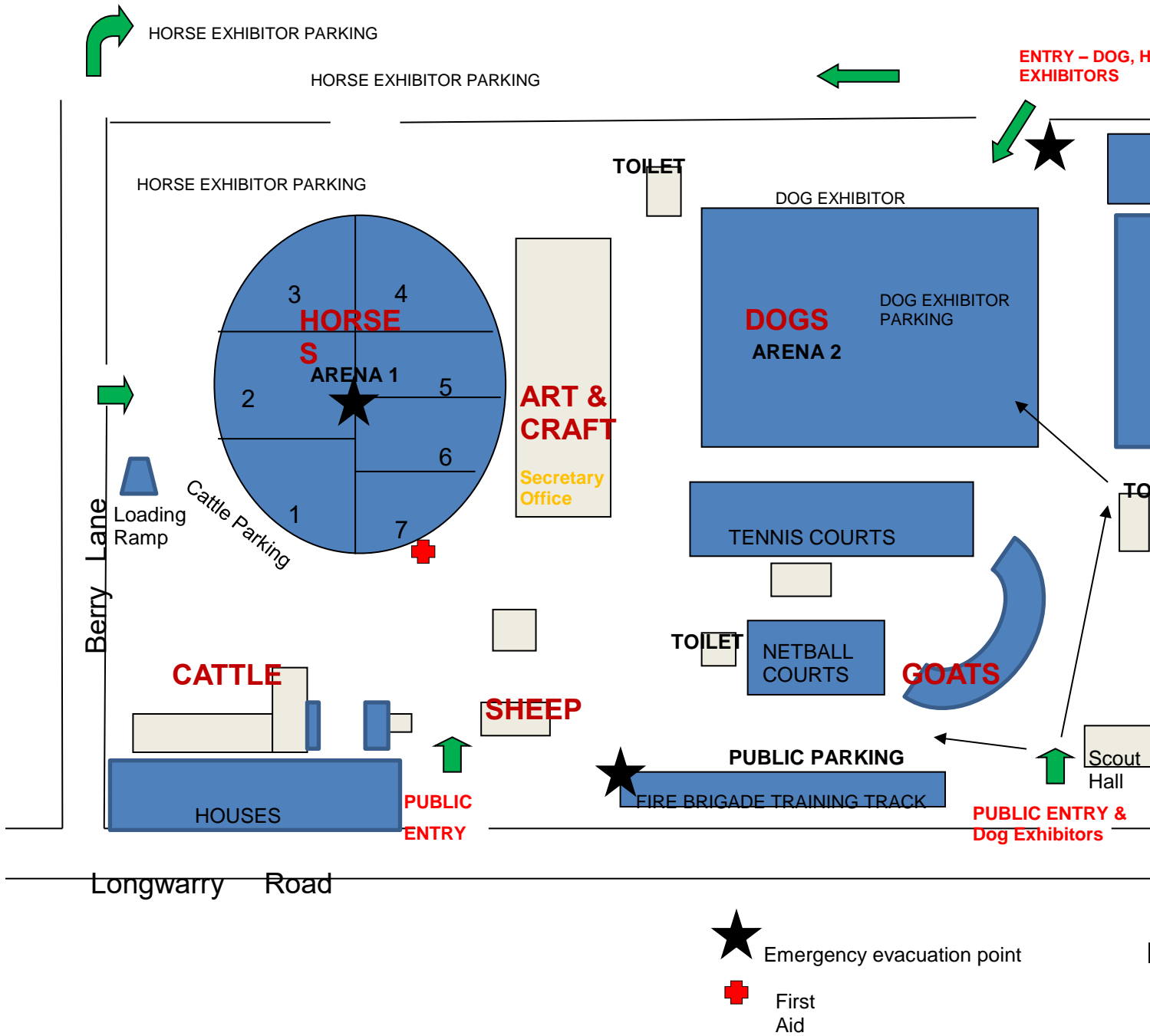

Horse Exhibitor entry will be by either second entrance on Berry Lane, or by entrance on Modella Road.

# HORSE SECTION:

## VAS Ltd. And Racing Victoria "Off The Track" series

All horse entry fees unless otherwise stated:

**Exhibitor Ticket Holder: \$2,**  
**Non-Ticket Holder: \$4**  
**Entries on the Day: \$7**

Re-training  
retired racehorses.  
The ideal  
equestrian athletes.



### ARENA 1. RING 1 START: 9am

#### OPEN CLASSES RING 1

Exhibits are only eligible to compete in their ridden show hunter classes **or** their ridden open classes at this show. They are not eligible to compete in both. Exhibits found to be contravening this rule will be disqualified.

**Prizes: 1st 2nd & 3rd = Ribbon**

A1	<b>Special Event:</b> <b>"Off The Track" Ridden Hack</b> <ul style="list-style-type: none"> <li>- Sponsored by Racing Victoria</li> <li>- Winner eligible to compete at VAS Ltd. Saddlehorse Championships - January 2018</li> </ul> <p style="text-align: center;">   </p> <b>Class Winner to receive \$50 and a Prize pack (posted by VAS Ltd. After notification of Win by Bunyip Agricultural Society)</b>
A2	Novice Hack over 15h.
A3	Open Hack over 15h and not over 15.2h.
A4	Open Hack over 15.2h and not over 16h.
A5	Open Hack over 16h and not over 16.2h.
A6	Open Hack over 16.2h.
	<b>CHAMPION HACK &amp; RESERVE CHAMPION HACK</b>
A7	Show Hunter Hack over 15h and not over 16h.
A8	Show Hunter Hack over 16h.
	<b>CHAMPION &amp; RESERVE CHAMPION SHOW HUNTER HACK</b>
A9	Rider 18 years and under 21 years.
A10	Rider 21 years and over.
	<b>CHAMPION &amp; RESERVE CHAMPION SENIOR RIDER</b>
A11	Open Galloway over 14h and not over 14.2h.
A12	Open Galloway over 14.2h and not over 15h.
	<b>CHAMPION &amp; RESERVE CHAMPION GALLOWAY</b>
A13	Show Hunter Galloway over 14h & not over 14.2h.
A14	Show Hunter Galloway over 14.2h & not over 15h.
	<b>CHAMPION &amp; RESERVE CHAMPION SHOW HUNTER GALLOWAY</b>
A15	Open Pony over 13.2h and not over 14h.
A16	Open Pony over 13h and not over 13.2h.
A17	Open Pony over 12.2h and not over 13h.
	<b>CHAMPION &amp; RESERVE CHAMPION PONY OVER 12.2H AND NOT OVER 14H</b>
A18	Open Pony over 12h and not over 12.2h.
A19	Open Pony over 11.2h and not over 12h.
A20	Open Pony over 11h and not over 11.2h.
A21	Open Pony 11h and under.
	<b>CHAMPION &amp; RESERVE CHAMPION PONY 12.2H AND UNDER</b>
A22	Show Hunter Pony not over 12h.
A23	Show Hunter Pony over 12h & not over 13h.
A24	Show Hunter Pony over 13 h & not over 14h.
	<b>CHAMPION &amp; RESERVE CHAMPION SHOW HUNTER PONY</b>

1. Open to all thoroughbreds unraced or raced 4 years and over, over 14.2 hands who are registered with RISA (Racing Information Services Australia). Registrations will be checked.
2. Racing name to be used where appropriate. When entering if name is different to racing name, or if never raced please provide the following details (if known)
  - Racing name
  - Brands, colour and markings
  - Microchip number
  - Life Number
  - Registration Certificate Number
3. Qualifying Shows must be affiliated with VAS Ltd
4. Qualifying classes will be judged ridden
5. Once a qualifier is won, the horses cannot compete in other qualifiers
6. All qualifying winners gain automatic entry into the Off the Track series Final to be held at the 2016 VAS Ltd Saddle Horse Championships - January 2016
7. Riders to be 14 years and over on day of qualifying show
8. To be judged as a good example of Thoroughbreds rather than riding horse/hunter types with the following being taken into consideration:
  - Thoroughbred qualities
  - Conformation
  - Manners, paces and performance
  - Injuries caused through racing such as blemishes are allowed
9. Judges decision is final in qualifiers and final
10. Qualifier Prizes: \$50, sash, card and Racing Victoria Prize

### ARENA 1. RING 2 START: 9am

#### OPEN CLASSES RING 2

Exhibits are only eligible to compete in their ridden show hunter classes **or** their ridden open classes at this show. They are not eligible to compete in both. Exhibits found to be contravening this rule will be disqualified.

**Prizes: 1st 2nd & 3rd = Ribbon**

B1	Novice Galloway over 14h and not over 15h.
B2	Open Galloway over 14h and not over 14.2h.
B3	Open Galloway over 14.2h and not over 15h.
	<b>CHAMPION GALLOWAY &amp; RESERVE CHAMPION GALLOWAY</b>
B4	Show Hunter Galloway over 14h & not over 14.2h.
B5	Show Hunter Galloway over 14.2h & not over 15h.
	<b>CHAMPION &amp; RESERVE CHAMPION SHOW HUNTER GALLOWAY</b>
B6	Rider 16 years and under 18 years.
B7	Rider 14 years and under 16 years.
B8	Rider 12 years and under 14 years.
	<b>CHAMPION &amp; RESERVE CHAMPION INTERMEDIATE RIDER</b>
B9	Open Pony over 13.2h and not over 14h.
B10	Open Pony over 13h and not over 13.2h.
B11	Open Pony over 12.2h and not over 13h.
	<b>CHAMPION &amp; RESERVE CHAMPION PONY OVER 12.2H AND NOT OVER 14H</b>
B12	Open Pony over 12h and not over 12.2h.
B13	Open Pony over 11.2h and not over 12h.
B14	Open Pony over 11h and not over 11.2h.
B15	Open Pony under 11h.
	<b>CHAMPION &amp; RESERVE CHAMPION PONY 12.2H AND UNDER</b>
B16	Show Hunter Pony not over 12h.
B17	Show Hunter Pony over 12h & not over 13h.

B18	Show Hunter Pony over 13 h & not over 14h.
	<b>CHAMPION &amp; RESERVE CHAMPION SHOW HUNTER PONY</b>
B19	Open Hack over 15h and not over 15.2h.
B20	Open Hack over 15.2h and not over 16h.
B21	Open Hack over 16h and not over 16.2h.
B22	Open Hack over 16.2h.
	<b>CHAMPION &amp; RESERVE CHAMPION HACK</b>
B23	Show Hunter Hack over 15h and not over 16h.
B24	Show Hunter Hack 16h and over.
	<b>CHAMPION &amp; RESERVE CHAMPION SHOW HUNTER HACK</b>

### ARENA 1. RING 3 START: 9am

### PALOMINO CLASSES

Prizes: 1st 2nd & 3rd = Ribbon

C1	Best Presented.
C2	Best Mane & Tail
C3	Led Stallion or Colt.
C4	Led Mare or Filly.
C5	Led Gelding.
	<b>CHAMPION &amp; RESERVE CHAMPION LED PALOMINO (classes C3 to C5 eligible)</b>
C6	Ridden Palomino.

### ARENA 1. RING 3 START: after Palomino

### MOUNTAIN & MOORLAND/FJORD CLASSES

SPONSORED BY HIGHLAND PONIES AUSTRALIA

Eligible breeds: New Forrest, Connemara, Highland, Dartmoor, Fell, Fjord

All horses/ponies must be registered with their relevant breed societies

Prizes: 1st 2nd & 3rd = Ribbon

D1	Led Male, any age.
D2	Led Female, any age
	<b>CHAMPION &amp; RESERVE CHAMPION LED</b> Rosettes donated by Highland Ponies Australia
D3	Ridden Mountain & Moorland/Fjord.

### ARENA 1. RING 3 START: After Mountain & Moorland/Fjord,

### OPEN CLASSES RING 3

Exhibits are only eligible to compete in their ridden show hunter classes **or** their ridden open classes at this show. They are not eligible to compete in both. Exhibits found to be contravening this rule will be disqualified.

Prizes: 1st 2nd & 3rd = Ribbon

E1	Miniature Turnout under 8 years, 10.2h & under.
E2	First Ridden Pony 12.2h & under. Rider 8 yrs & under.
E3	Novice Pony 14h and under
E4	Open Pony over 13.2h and not over 14h.
E5	Open Pony over 13h and not over 13.2h.
E6	Open Pony over 12.2h and not over 13h.
	<b>CHAMPION &amp; RESERVE CHAMPION PONY OVER 12.2H AND NOT OVER 14H</b>
E7	Show Hunter Pony not over 12h.
E8	Show Hunter Pony over 12h & not over 13h.
E9	Show Hunter Pony over 13 h & not over 14h.
	<b>CHAMPION &amp; RESERVE CHAMPION SHOW HUNTER PONY</b>
E10	Open Pony over 12h and not over 12.2h.
E12	Open Pony over 11.2h and not over 12h.

E13	Open Pony over 11h and not over 11.2h.
E14	Open Pony 11h and under.
	<b>CHAMPION &amp; RESERVE CHAMPION PONY 12.2H AND UNDER</b>
E15	Rider 10 years and under 12 years.
E16	Rider 8 years and under 10 years.
E17	Rider under 8 years.
	<b>CHAMPION &amp; RESERVE CHAMPION JUNIOR RIDER</b>
E18	Open Hack over 15h and not over 15.2h.
E19	Open Hack over 15.2h and not over 16h.
E20	Open Hack over 16h and not over 16.2h.
E21	Open Hack over 16.2h.
	<b>CHAMPION &amp; RESERVE CHAMPION HACK</b>
E22	Show Hunter Hack over 15h and not over 16h.
E23	Show Hunter Hack 16h and over.
	<b>CHAMPION &amp; RESERVE CHAMPION SHOW HUNTER HACK</b>
E24	Open Galloway over 14h and not over 14.2h.
E25	Open Galloway over 14.2h and not over 15h.
	<b>CHAMPION &amp; RESERVE CHAMPION GALLOWAY</b>
E26	Show Hunter Galloway over 14h & not over 14.2h.
E27	Show Hunter Galloway over 14.2h & not over 15h.
	<b>CHAMPION &amp; RESERVE CHAMPION SHOW HUNTER GALLOWAY</b>

### ARENA 1. RING 4 START: 9am

### OPEN LED CLASSES (A)

Prizes: 1st 2nd & 3rd = Ribbon

**Champions from this section qualify for Supreme Open Led (held at conclusion of Open Led Classes B - in Ring 6)**

F1	Stallion, 4 years and over.
F2	Colt, 2 and 3 years.
F3	Colt, yearling or under.
	<b>CHAMPION &amp; RESERVE CHAMPION STALLION/COLT</b>
F4	Mare, 4 years and over.
F5	Filly, 2 and 3 years.
F6	Filly, yearling or under.
	<b>CHAMPION &amp; RESERVE CHAMPION MARE/FILLY</b>
F7	Gelding, 4 years and over.
F8	Gelding, 2 and 3 years.
F9	Gelding, yearling or under.
	<b>CHAMPION &amp; RESERVE CHAMPION GELDING</b>

## ARENA 1. RING 4 START: after Open Led

### LED SHOW HUNTER, FIRST SEASON RIDDEN & JUNIOR EXHIBITOR CLASSES

First Season Exhibits must be ridden in a snaffle bit only Junior Exhibitor classes open to riders 18 years and under only  
**Prizes: 1st 2nd & 3rd = Ribbon**

G1	Led Show Hunter Hack over 15h and not over 16h.
G2	Led Show Hunter Hack 16h and over.
G3	Led Show Hunter Galloway over 14h & not over 14.2h.
G4	Led Show Hunter Galloway over 14.2h & not over 15h.
G5	Led Show Hunter Pony not over 12h.
G6	Led Show Hunter Pony over 12h & not over 13h.
G7	Led Show Hunter Pony over 13 h & not over 14h.
	<b>CHAMPION &amp; RESERVE CHAMPION LED SHOW HUNTER</b>
	<b>FIRST SEASON CLASSES</b>
G8	First season ridden shetland
G9	First season ridden pony 12.2h & under
G10	First season ridden pony over 12.2h & not over 13h
G11	First season ridden pony 13h & not over 14h.
	<b>CHAMPION &amp; RESERVE CHAMPION FIRST SEASON RIDDEN PONY</b>
G12	First season ridden Galloway over 14h & not over 14.2h
G13	First season ridden Galloway 14.2h & not over 15h
	<b>CHAMPION &amp; RESERVE CHAMPION FIRST SEASON RIDDEN GALLOWAY</b>
G14	First season ridden Hack 15h & not over 15.2h
G15	First season ridden Hack over 15.2h and not over 16h.
G16	First season ridden Hack over 16h.
	<b>CHAMPION &amp; RESERVE CHAMPION FIRST SEASON RIDDEN HACK</b>
	<b>JUNIOR EXHIBITOR CLASSES</b>
G17	Open Pony over 13h and not over 14h.
G18	Open Pony over 12h and not over 13h.
G19	Open Pony over 12h and under.
	<b>JUNIOR EXHIBITOR CHAMPION &amp; RESERVE CHAMPION PONY</b>
G20	Open Galloway over 14h and not over 14.2h.
G21	Open Galloway over 14.2h and not over 15h.
	<b>JUNIOR EXHIBITOR CHAMPION &amp; RESERVE CHAMPION GALLOWAY</b>
G22	Open Hack over 15h and not over 16h.
G23	Open Hack over 16h.
	<b>JUNIOR EXHIBITOR CHAMPION &amp; RESERVE CHAMPION HACK</b>
G24	Show Hunter Pony 12h and under
G25	Show Hunter Pony over 12h and not over 14h.
G26	Show Hunter Galloway
G27	Show Hunter Hack
	<b>JUNIOR EXHIBITOR CHAMPION &amp; RESERVE CHAMPION SHOW HUNTER</b>

## ARENA 1. RING 5 START: 9am

### BUCKSKIN CLASSES

**SPONSORED BY NATIONAL BUCKSKIN SOCIETY**

All horses must be registered with the National Buckskin Society, and all exhibitors must be current financial members.

**Prizes: 1st 2nd & 3rd = Ribbon**

H1	Best Presented Buckskin Exhibit (No workout required)
H2	Led Stallion, 4 years and over.
H3	Led Colt, 3 years & under.
	<b>CHAMPION &amp; RESERVE CHAMPION LED STALLION OR COLT</b>
H4	Led Mare, 4 years & over.
H5	Led Filly, 3 years & under.
	<b>CHAMPION &amp; RESERVE CHAMPION LED FEMALE</b>
H6	Led Gelding, 4 years & over.
H7	Led Gelding, 3 years & under.
	<b>CHAMPION &amp; RESERVE LED GELDING</b>
	<b>SUPREME CHAMPION LED BUCKSKIN</b>
H8	Ridden Buckskin, over 13 h
H9	Ridden Buckskin, 13 h & under.
	<b>CHAMPION AND RESERVE CHAMPION RIDDEN BUCKSKIN</b>
H10	Ridden Pleasure Buckskin
	<b>SECTION B &amp; C (must be NBS registered and financial members)</b>
H11	Best Presented Section B & C (no workout required)
H12	Led Section B & C Male
H13	Led Section B & C Female
	<b>CHAMPION &amp; RESERVE LED SECTION B &amp; C</b>
H14	Ridden Section B & C Male
H15	Ridden Section B & C Female
H16	Ridden Pleasure Section B & C

## ARENA 1. RING 5 START: after Buckskins

### MINIATURE PONY CLASSES

All Ponies to be registered with the Australian Miniature Pony Society and exhibitors must be current financial members. Height not to exceed 87 cm.

**Prizes: 1st 2nd & 3rd = Ribbon**

K1	Led Stallion 4 years & over.
K2	Led Colt 2 & 3 years.
K3	Led Colt yearling.
	<b>CHAMPION &amp; RESERVE CHAMPION LED MALE</b>
K4	Brood Mare visibly in foal or foal at foot.
K5	Foal.
K6	Led Mare 4 years & over (Mares entered in above class are ineligible.)
K7	Led Filly 2 & 3 years.
K8	Led Filly yearling
	<b>CHAMPION &amp; RESERVE CHAMPION LED FEMALE</b>
K9	Led Gelding 4 years & over.
K10	Led Gelding 3 years & under.
	<b>CHAMPION &amp; RESERVE CHAMPION LED GELDING</b>
	<b>SUPREME LED EXHIBIT</b>
K11	Junior Handler 10 years & under.
K12	Junior Handler 11 years & under 16 years.
K13	Junior Rider 6 years & under.
K14	Miniature in Harness.

## ARENA 1. RING 5 START: after Miniature Ponies

### FUN RING CLASSES

Competitors Under 18 years

Entry Fee: \$1.00 (Tickets may be purchased on Show Day.)

This ring has been designed for children who do not show on a regular basis. Please be considerate and leave this ring to these children. Protective Headgear essential when mounted. No riding jackets allowed. Snaffle bit only.

Prizes: Ribbons to 6th Place.

For safety reasons classes may be divided at the discretion of the Ring Master and Judge.

M1	Fancy Dress, 6 years & under, may be Led
M2	Fancy Dress, 7 years & under 10 years.
M3	Fancy Dress, 10 years & over.
M4	Child Handler, 6 years & under.
M5	Child Handler, 7 years & under 10 years.
M6	Child Handler, 10 years & over.
M7	Best Broken Coloured Pony or Horse.
M8	Best Solid Coloured Pony or Horse.
M9	Horse or Pony with the tail closest to the ground.
M10	Smallest Pony under 14 hands.
M11	Tallest Horse 14 hands and over.
M12	Prettiest Horse or Pony.
M13	Horse or Pony most like its Owner.

## ARENA 1. RING 5 START: after Fun Ring

### ARABIAN DERIVATIVE CLASSES

Registration Certificate must be produced on demand. Registered with A.H.S.A.

Prizes: 1st 2nd & 3rd = Ribbon

N1	Colt Yearling or under.
N2	Colt, 2 years and 3 years.
N3	Stallion 4 years and over.
	<b>CHAMPION &amp; RESERVE CHAMPION STALLION/COLT.</b>
N4	Mare 4 years and over.
N5	Filly 2 and 3 years.
N6	Filly Yearling or under.
	<b>CHAMPION &amp; RESERVE CHAMPION MARE/FILLY</b>
N7	Gelding 4 years and over.
N8	Gelding 2 and 3 years.
N9	Gelding Yearling or under.
	<b>CHAMPION &amp; RESERVE CHAMPION GELDING.</b>
N10	Ridden Derivative Mare.
N11	Ridden Derivative Male.
	<b>CHAMPION &amp; RESERVE CHAMPION RIDDEN ARABIAN DERIVATIVE.</b>

## ARENA 1. RING 6 START: 9am

### SHETLAND PONY CLASSES

Exhibitors must be current financial members of the Australian Pony Stud Book Society.

Prizes: 1st 2nd & 3rd = Ribbon

P1	Shetland Pony Stallion, 4 years and over.
P2	Shetland Colt, 2 and 3 years.
P3	Yearling Colt.
	<b>CHAMPION &amp; RESERVE CHAMPION MALE</b>
P4	Shetland Pony Gelding, 4 years and over.
P5	Shetland Pony Gelding, 2 and 3 years.
P6	Yearling Gelding.
	<b>CHAMPION &amp; RESERVE CHAMPION GELDING</b>

P7	Shetland Pony Mare, not over 9.2h, 4 years and over.
P8	Shetland Pony Mare, over 9.2h, 4 years and over.
P9	Shetland Pony Filly, 2 years and 3 years.
P10	Yearling Filly
	<b>CHAMPION &amp; RESERVE CHAMPION FEMALE</b>
	<b>SUPREME LED SHETLAND</b>
P11	Ridden Shetland.

## ARENA 1. RING 6 START: After Shetlands WELSH CLASSES

Welsh Classes are generously supported by the Gippsland & Peninsula Regional Promotional Group.

All ponies entered in this section must be registered in the Welsh Section of the A.P.S.B. or with the Welsh Pony & Cob Society of Australia or in the Purebred Section of any recognised Welsh Stud Book. Registration numbers and names must be entered on the Entry Form & exhibitor must be a current financial member of the Welsh Pony & Cob Society of Australia or the Australian Pony Stud Book Society.

Prizes: 1st 2nd & 3rd = Ribbon

#### SECTION A: WELSH MOUNTAIN

R1	Colt, 3 & Under
R2	Stallion 4 & Over.
	<b>CHAMPION &amp; RESERVE STALLION OR COLT</b>
R3	Filly Yearling.
R4	Filly, 2 & 3 Years.
R5	Mare, 4 & Over.
	<b>CHAMPION &amp; RESERVE MARE OR FILLY</b>

#### SECTION B: WELSH PONIES

R6	Colt 3 & Under.
R7	Stallion 4 & Over.
	<b>CHAMPION &amp; RESERVE STALLION OR COLT</b>
R8	Filly Yearling.
R9	Filly, 2 & 3 Years.
R10	Mare, 4 & Over.
	<b>CHAMPION &amp; RESERVE MARE OR FILLY</b>

#### SECTIONS C & D: WELSH COBS

R11	Led Stallion or Colt.
R12	Led Mare or Filly.
	<b>CHAMPION &amp; RESERVE WELSH COB C &amp; D</b>

#### SECTION E: WELSH GELDINGS

R13	Led Gelding Under 12.2 Hands .
R14	Led Gelding, 12.2 Hands & Under 13 Hands.
R15	Led Gelding, 13 Hands & Over.
	<b>CHAMPION &amp; RESERVE GELDING — ELIGIBLE FOR SUPREME LED EXHIBIT</b>

#### PART WELSH (NOT ELIGIBLE FOR SUPREME EXHIBIT)

R16	Led Stallion or Colt.
R17	Led Filly, 3 & Under.
R18	Led Mare, 4 & Over.
R19	Led Part Welsh Gelding.
	<b>CHAMPION &amp; RESERVE LED PART WELSH RIDDEN</b>
R20	Ridden Stallion - Section A, B, C & D.
R21	Ridden Mare - Section A, B, C & D.
R22	Ridden Gelding - Section E.
R23	Ridden Part Welsh Mare, Stallion or Gelding.
	<b>CHAMPION &amp; RESERVE CHAMPION RIDDEN WELSH EXHIBIT</b>

#### SUPREME LED WELSH EXHIBIT

(PART WELSH NOT ELIGIBLE)

SASH DONATED BY GIPPSLAND & PENINSULA REGIONAL PROMOTIONAL GROUP





## ARENA 1. RING 6 START: After Welsh

### OPEN LED CLASSES (B)

Prizes: 1st 2nd & 3rd = Ribbon

**Champions from this section qualify for Supreme Open Led (held at conclusion of Open Led Classes B - in Ring 6)**

S1	Stallion, 4 years and over.
S2	Colt, 2 and 3 years.
S3	Colt, yearling or under.
	<b>CHAMPION &amp; RESERVE CHAMPION STALLION/COLT</b>
S4	Mare, 4 years and over.
S5	Filly, 2 and 3 years.
S6	Filly, yearling or under.
	<b>CHAMPION &amp; RESERVE CHAMPION MARE/FILLY</b>
S7	Gelding, 4 years and over.
S8	Gelding, 2 and 3 years.
S9	Gelding, yearling or under.
	<b>CHAMPION &amp; RESERVE CHAMPION GELDING</b>

### SUPREME OPEN LED

Prize: \$200 plus Trophy or garland  
(champions from Open Led Classes A and B eligible to compete)

Generously sponsored by:

**Essential Equine Veterinary**

ph: 0400 111 838

email: eev@bigpond.com

## ARENA 1. RING 7 START: 9am

### AUSTRALIAN PONIES

All ponies entered in this section must be registered or Foal Recorded in the Australian Sections of the A.P.S.B. Ponies must be entered in the name of the registered owner who must be a current financial member of the A.P.S.B. Society Inc.

Prizes: 1st 2nd & 3rd = Ribbon

T1	Led Youngstock, Colt, Filly or Gelding 3 years & under, 14h & under.
T2	Led Stallion 4 years & over, 14h & under.
T3	Led Mare 4 years & over, 14h & under.
T4	Led Gelding 4 years & over, 14h & under.
	<b>CHAMPION &amp; RESERVE CHAMPION LED A.P.S.B. PONY</b>
T5	Ridden Stallion 14h & under.
T6	Ridden Mare 14h & under.
T7	Ridden Gelding 14h & under.
	<b>CHAMPION &amp; RESERVE CHAMPION RIDDEN A.P.S.B. PONY</b>

### A.P.S.B. PART-BREDS

(Not eligible for any other classes other than A.P.S.B. Part Bred.)

T8	Led Male.
T9	Led Female.
	<b>CHAMPION &amp; RESERVE CHAMPION LED A.P.S.B. PART-BRED PONY</b>
T10	Ridden Male
T11	Ridden Female
	<b>CHAMPION &amp; RESERVE CHAMPION RIDDEN PART BRED PONY</b>

### A.P.S.B. RIDING PONIES

(Not eligible for any other classes other than A.P.S.B. Riding Pony.)

T12	Led Stallion or Colt
T13	Led Mare or Filly
T14	Led Gelding
	<b>CHAMPION &amp; RESERVE CHAMPION A.P.S.B. RIDING PONY – LED</b>
T15	Ridden Male
T16	Ridden Female
	<b>CHAMPION &amp; RESERVE CHAMPION A.P.S.B. RIDING PONY – RIDDEN</b>

## ARENA 1. RING 7 START: After Australian Ponies

### PINTO CLASSES

All Pintos must be registered with the Victorian Pinto Society. Exhibitors/Owners to be financial members of the Victorian Pinto Society.

Prizes: 1st 2nd & 3rd = Ribbon

W1	Led Stallion or Colt 10.2h & under.
W2	Led Mare or Filly 10.2h & under.
W3	Led Gelding 10.2h & under.
	<b>CHAMPION &amp; RESERVE CHAMPION LED PINTO 10.2 H &amp; UNDER</b>
W4	Led Stallion or Colt over 10.2h & under 14h.
W5	Led Stallion or Colt 14h & over.
	<b>CHAMPION &amp; RESERVE CHAMPION LED STALLION OR COLT</b>
W6	Led Mare or Filly over 10.2h & under 14h.
W7	Led Mare or Filly 14h & over.
	<b>CHAMPION &amp; RESERVE CHAMPION LED MARE OR FILLY</b>
W8	Led Gelding over 10.2h & under 14h.
W9	Led Gelding 14h and over.
	<b>CHAMPION &amp; RESERVE CHAMPION GELDING</b>
	<b>SUPREME CHAMPION LED PINTO EXHIBIT</b>
W10	Ridden Pinto 14 h & over.
W11	Ridden Pinto over 10.2h & under 14 h.
W12	Ridden Pinto 10.2h & under.
	<b>CHAMPION &amp; RESERVE RIDDEN PINTO</b>

## ARENA 1. RING 7 START: After Pinto AUSTRALIAN STOCKHORSE CLASSES HI POINT SHOW

**RING PROUDLY SPONSORED BY WEST GIPPSLAND ASH BRANCH**

All exhibits must be registered or foal recorded ASH.

Papers to be produced on request.

Prizes: 1st 2nd & 3rd = Ribbon

X1	Led Stallion, 4 years & over.
X2	Led Gelding 4 years & over.
X3	Led Colt or Gelding, 3 years & under.
	<b>CHAMPION &amp; RESERVE CHAMPION LED MALE</b>
X4	Led Mare, 4 years & over.
X5	Led Filly 3 years & under.
	<b>CHAMPION &amp; RESERVE CHAMPION LED FEMALE</b>
	<b>SUPREME LED STOCKHORSE</b>
X6	ASHLA – must be financial member of ASHLA to



	compete
X7	Novice Ridden Stockhorse
X8	Ridden Stockhorse 3 years & under
X9	Junior Ridden Stockhorse (under 18 years)
X10	Ridden Stockhorse Mare
X11	Ridden Stockhorse Stallion
X12	Ridden Stockhorse Gelding
	<b>CHAMPION &amp; RESERVE CHAMPION RIDDEN STOCKHORSE</b>
X13	Novice Working Stockhorse
X14	Working Stockhorse 3 years and under
X15	Junior Working Stockhorse (under 18 years)
X16	Working Stockhorse Mare
X17	Working Stockhorse Stallion
X18	Working Stockhorse Gelding
	<b>CHAMPION &amp; RESERVE CHAMPION WORKING STOCKHORSE</b>
X19	Pleasure Horse
X20	Station Horse

## SOCIETY RULES AND REGULATIONS

### GENERAL

1. Entries to the show are accepted subject to the Rules & Regulations of the Society and the entrant agrees to be bound by those Rules and Regulations.
2. The entrant also agrees to abide by all decisions made by the Society, by the group with which it is affiliated or by VAS Ltd. Pursuant to those Rules and Regulations and by-laws.
3. In case of dispute as to the construction of these regulations the same will be determined by the Society.
4. Entry money MUST be forwarded with entries. Cheques, postal notes and money orders must be made payable to Bunyip & District Agricultural Society Inc.
5. No refund on entry money.
6. Proof of age must be presented, if required, in children's events.
7. It shall be the duty of the Stewards to prevent anyone interfering with the judges and if necessary, order the removal of such offender from the ground.
8. The stewards have power to disqualify insolent exhibitors
9. The judges may award a second or third prize in place of a first or withhold prize altogether when the exhibits are not of sufficient merit.
10. All persons exhibiting shall accept the decision of the judges appointed by the Society, and in case of protests, the decision of the Disputes Committee shall be final and without appeal.
11. All protests must be lodged before 5.00 p.m. on the day of the Show accompanied by a deposit of \$50 which will be forfeited if the Disputes Committee considers the protest frivolous.
12. The Society may withhold any prizes when statements have been erroneously made regarding an exhibit and exhibitors guilty of false entries may be debarred from again exhibiting and if members, will be expelled from the Society.
13. The Society reserves the right to substitute trophies for prize money in any section.
14. All prizes and prize money NOT COLLECTED by 5.00 p.m. on Show Day shall be FORFEITED.
15. THE SOCIETY RESERVES THE RIGHT TO ALTER OR AMEND THE PROGRAM AND ALTER OR SUBSTITUTE JUDGES IF NECESSARY.
16. The Society reserves the right to refuse admittance to or eject from the showgrounds any person. And refuse an exhibit or an exhibitor without giving any reason.

### LIVESTOCK

17. All livestock must show good health, be eating normally and not showing any signs of respiratory disease during the last 3 days prior to the show. The Society has the right to call for a veterinary inspection of any animal suspected of illness at any time during the course of the show, fees incurred to be paid by the exhibitor.
18. In the event of a restriction of movement of livestock due to diseases such as equine influenza, exhibitors agree that a Standstill is a risk of competing at this event and agree to pay all costs or expenses incurred by themselves and their livestock as a result of the quarantine period.
19. The Society reserves the right of refusing to admit any exhibit into the Showgrounds which they have reason to suspect is diseased, dangerous or otherwise disapproved of as an exhibit and of removing such exhibit from the Showgrounds.
20. All Riders ride at their own risk and wear headgear to the current approved standard.

21. Stallions must be under the control of a responsible person aged 18 years or older.

22. Stallions are permitted to compete in their respective classes as stated in the schedule, and their ridden breed classes only. They are not permitted to compete in the Fun Ring events, or in open classes, with the exception of the Bunyip saddle horse challenge (class SC1).

### PAVILION

23. Every person making a Pavilion entry will receive a ticket stating Section and Number from Secretary on staging exhibits.

24. Each Pavilion exhibitor must place his or her exhibit in the proper class where directed by the Steward, with the ticket received from the Secretary attached to exhibit.

25. Pavilion exhibits must not be removed before 3.15 p.m.

26. Persons in charge of exhibits must conform to the direction of the Stewards as to the placing, removal and custody of their exhibits and shall leave the place of Judging before the judging begins, unless directed by the Stewards to remain.

27. Exhibitors refusing to attach prize card to any exhibit to which a prize has been awarded and to keep same on during the exhibition will, on proof thereof to the committee be disqualified from receiving any prizes awarded such exhibit.

28. All produce must be grown by the exhibitor and goods or other exhibits made by the exhibitor.

29. To be eligible for Most Successful Exhibitor, Classes must have 2 or more entries.

### RISK MANAGEMENT & PUBLIC LIABILITY

30. Bunyip and District Agricultural Society Inc. (the Society) is committed to providing a safe, healthy and environmentally acceptable showgrounds for all stakeholders. We shall maintain an effective health and safety program so far as practicable and endeavour to comply with all Statutory and Common Law requirements.

31. All competitors and exhibitors have a "Duty of Care" to avoid exposing themselves or other people to unsafe situations that could lead to injury.

32. The Society will not tolerate abusive, aggressive behaviour and bad language. Any incidents of this type may result in disqualification from any or all events, and removal from the Showgrounds.

33. All competitors and exhibitors shall take part in competitions or attend their exhibits at their own risk and in case any exhibit whilst on the Society's grounds shall cause or because of injury or damage to other exhibits, competitors or exhibitors or to the purpose or property of any member of the Society or the general public, the owner or owners of such exhibit shall indemnify and keep indemnified the Society, its officers and members, property and effects from and against all damage, costs, claims expenses or liabilities incurred in connection with such exhibits.

34. All persons connected with or engaging in any risk or activity in the arena and other departments do so at their own risk.

35. It shall be a condition of entry to the showground that no person shall hold the Society responsible for any accident that may be caused thereon through or by any exhibit. Competitors also enter, ride and otherwise take part at their own risk.

36. The Society shall not in any circumstances hold itself responsible for any loss by fire, storm, and damage by water, flood or lightning. Exhibits and displays shall be accepted only on this condition.

37. In the lead up to, or on the day of the Show, the Society may choose to cancel any or all events in its discretion, in the event of adverse weather or another unforeseen emergency that may arise.

38. The Society accepts no liability for injury to honorary judges in discharge of their duties at the Show, or in travelling to and from the Show.

39. The greatest care is taken of all exhibits but the Society will not be responsible for any accident mistake, loss or damage from whatsoever cause arising. All exhibits are at the sole risk of the exhibitor.

40. That no side-show is allowed on the ground without payment of fee to be fixed by the Society according to the type and size of the side-show and they must have public liability insurance coverage.

41. All dogs owned by Showman's Guild members, competitors or general public, must be chained or held on a leash by owners.



## HORSE SPORTS PARTICIPANT RISK ACKNOWLEDGMENT & WAIVER

Name of participant:.....

Victorian Agricultural Shows Ltd and *Bunyip Agricultural Show Society* (together "**the Suppliers**") advise that participation in horse sports at an agricultural show or horse competition contains elements of risk, both obvious and inherent. Horse sports are dangerous recreational activities and horses can act in a sudden and unpredictable way, especially when frightened or hurt.

**By signing this waiver I acknowledged that:**

*participation in horse sports is a hazardous activity and may result in injury, loss, damage or death to me;*

*participation in horse sports requires certain skills. I declare that I have sufficient skills to be able to safely and properly participate in the events;*

*horses can act in a sudden and unpredictable way, especially if frightened or hurt, or if exposed to loud or unfamiliar noises;*

*if held at an agricultural show, the horse sports will be held in close proximity to rides and large groups of people, and that there may be loud and unfamiliar noises which can frighten horses;*

*as the event is held outdoors, there are risks to me and to my horse as a result of the weather conditions, including either extreme hot or cold weather, rain or wind;*

*insects or other animals may cause my horse or other horses to become frightened and act in an unpredictable way;*

*there is inherent in horse riding events the risk of suffering injury including falling from my horse;*

*I am responsible for ensuring that I have and will wear equipment suitable for safely and properly participating in the event; and*

*I use the facilities of [name of show society] entirely at my own risk, as I find them and with the prior acceptance of the risk of possible danger to me.*

**If I suffer harm while participating in a horse event, I will not hold the Suppliers, their employees or agents legally responsible for any injuries I suffer. I will not sue the Suppliers, their employees or agents for any claims, costs, damages or liability. I agree to release the Suppliers and their employees from legal responsibility for the services I have been provided.**

**I acknowledge and agree that my participation in the horse sports and associated activities are a danger and may have inherent risks as a result of which personal injury (and sometimes death) may occur and I accept and assume all such risks of personal injury or death in anyway whatsoever arising from these activities and hereby waive my individual right to sue the Suppliers for all claims I or my representatives may have for such personal injury or death against the Suppliers in any way whatsoever arising from or in connection with these activities.**

**I will not consume any alcohol or illicit drugs while participating in the horse sports and agree that such use may result in me being excluded from an event**

**with no entitlement to any refund of money paid for entry to the Suppliers.**

**I agree to be bound by the rules and guidelines of Victorian Agricultural Shows Ltd as varied from time to time.**

**Where the participant is over 18 years of age:**

I agree that I have read and understood this waiver prior to signing it and agree that this waiver will be binding on my heirs, next of kin, executors and administrators.

I agree that this waiver shall be governed in all respects by and interpreted in accordance with the laws of Victoria.

Signature: ..... Dated:

**Where participant is under 18 years of age (to be completed by a parent or guardian):**

I ....., being a parent or legal guardian of the above named participant hereby consent to my child participating in horse sports.

I confirm that I have read and understood and explained to the participant, this waiver prior to signing it and agree that this agreement will be binding on my (and their) heirs, next of kin, executors and administrators.

I agree that this waiver shall be governed in all respects by and interpreted in accordance with the laws of Victoria.

Signature: ..... Dated:

---

### WARNING UNDER THE FAIR TRADING ACT 1999

Under the Australian Consumer Law (Victoria), several statutory guarantees apply to the supply of certain goods and services. These guarantees mean that the supplier named on this form is required to ensure that the recreational services it supplies to you—

- are rendered with due care and skill; and
- are reasonably fit for any purpose which you, either expressly or by implication, make known to the supplier; and
- might reasonably be expected to achieve any result you have made known to the supplier.

Under section 32N of the **Fair Trading Act 1999**, the supplier is entitled to ask you to agree that these statutory guarantees do not apply to you. If you sign this form, you will be agreeing that your rights to sue the supplier under the **Fair Trading Act 1999** if you are killed or injured because the services provided were not in accordance with these guarantees, are excluded, restricted or modified in the way set out in this form.

**NOTE:** The change to your rights, as set out in this form, does not apply if your death or injury is due to gross negligence on the supplier's part. **Gross Negligence** is defined in the Fair Trading (Recreational Services) Regulations 2004.